



# TAI-SAW TECHNOLOGY CO., LTD.

No. 3, Industrial 2nd Rd., Ping-Chen Industrial District,  
Taoyuan, 324, Taiwan, R.O.C.

TEL: 886-3-4690038 FAX: 886-3-4697532

E-mail: [tstsales@mail.taisaw.com](mailto:tstsales@mail.taisaw.com) Web: [www.taisaw.com](http://www.taisaw.com)

## Approval Sheet For Product Specification

Issued Date: Apr, 7, 2007

Product Name: SAW Filter 300 MHz SMD 5.0X7.0 mm

TST Parts No.: TB0633A

Customer Parts No.: \_\_\_\_\_

Company: _____
Division: _____
Approved by : _____
Date: _____

Checked by: \_\_\_\_\_ Bob Chau

Approval by: \_\_\_\_\_ Francis Chen

Date: \_\_\_\_\_ 4, 7, 2008



# TAI-SAW TECHNOLOGY CO., LTD.

No. 3, Industrial 2nd Rd., Ping-Chen Industrial District,  
Taoyuan, 324, Taiwan, R.O.C.

TEL: 886-3-4690038 FAX: 886-3-4697532

E-mail: [tstsales@mail.taisaw.com](mailto:tstsales@mail.taisaw.com) Web: [www.taisaw.com](http://www.taisaw.com)

## SAW Filter 300 MHz

MODEL NO.:TB0633A

REV. NO.:1

### A. MAXIMUM RATING:

1. Input Power Level: 20 dBm
2. DC Voltage : 5V
3. Operating Temperature: 0°C to +80°C
4. Storage Temperature: -40°C to +85°C

RoHS Compliant  
Lead free  
Lead-free soldering

### B. ELECTRICAL CHARACTERISTICS:

Item	Unit	Min.	Type.	Max.	Note
Center frequency <b>Fc</b>	MHz	-	300	-	-
Min. Insertion loss, ( <b>Fc</b> ±50KHz ) <b>ILc</b>	dB	-	3.7	7.0	-
Passband Ripple ( <b>Fc</b> ±50KHz )	dB	-	0.4	2	-
Return Loss ( <b>Fc</b> ±50KHz ) <b>RL</b>	dB	9.4	13.5	-	-
<b>Attenuation</b> (relative to <b>ILc</b> )					
<b>Fc</b> -25 to <b>Fc</b> -1.6 MHz	dB	50	62	-	-
<b>Fc</b> -1.6 to <b>Fc</b> -0.6 MHz	dB	28	62	-	-
<b>Fc</b> +0.6 to <b>Fc</b> +1.6 MHz	dB	28	53	-	-
<b>Fc</b> +1.6 to <b>Fc</b> +25 MHz	dB	50	57	-	-
<b>Temperature coefficient of frequency</b> <b>TCf</b>		-0.033 ppm/C <sup>2</sup>			

### C.OUTLINE DRAWING:

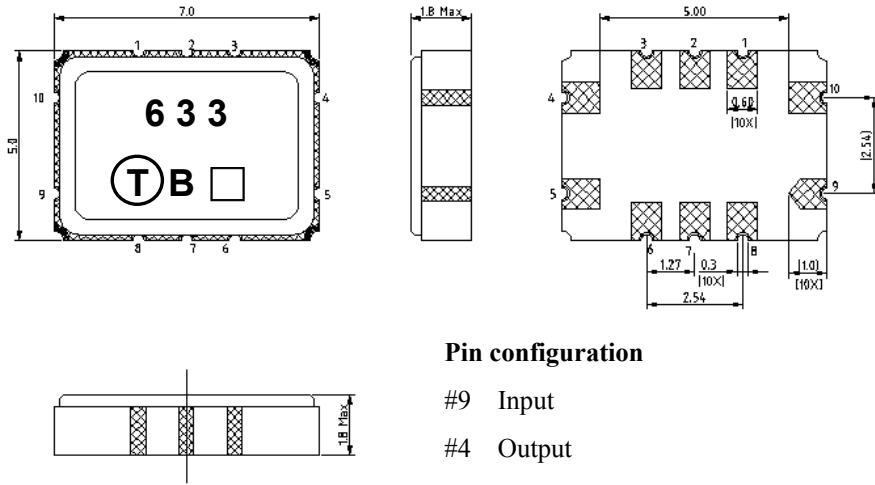

#### Pin configuration

- #9 Input
- #4 Output
- #10 Balance input or input ground
- #5 Balance output or output ground
- #1,2,3,6,7,8 To be grounded

□ Date code

Unit mm

#### Product Year Code

Year	2001 2005	2002 2006	2003 2007	2004 2008
Product Code	B	b	<u>B</u>	<u>b</u>

### D. MEASUREMENT CIRCUIT:

50 Ohm Test circuit ( single-ended / single-ended )

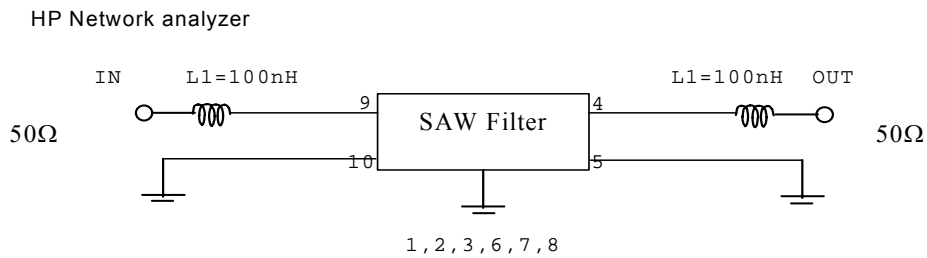

**E. PCB Footprint:**

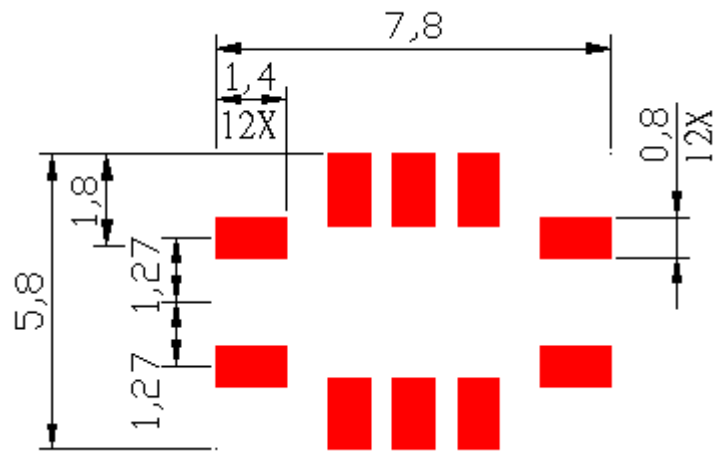

## F. Frequency Characteristics :

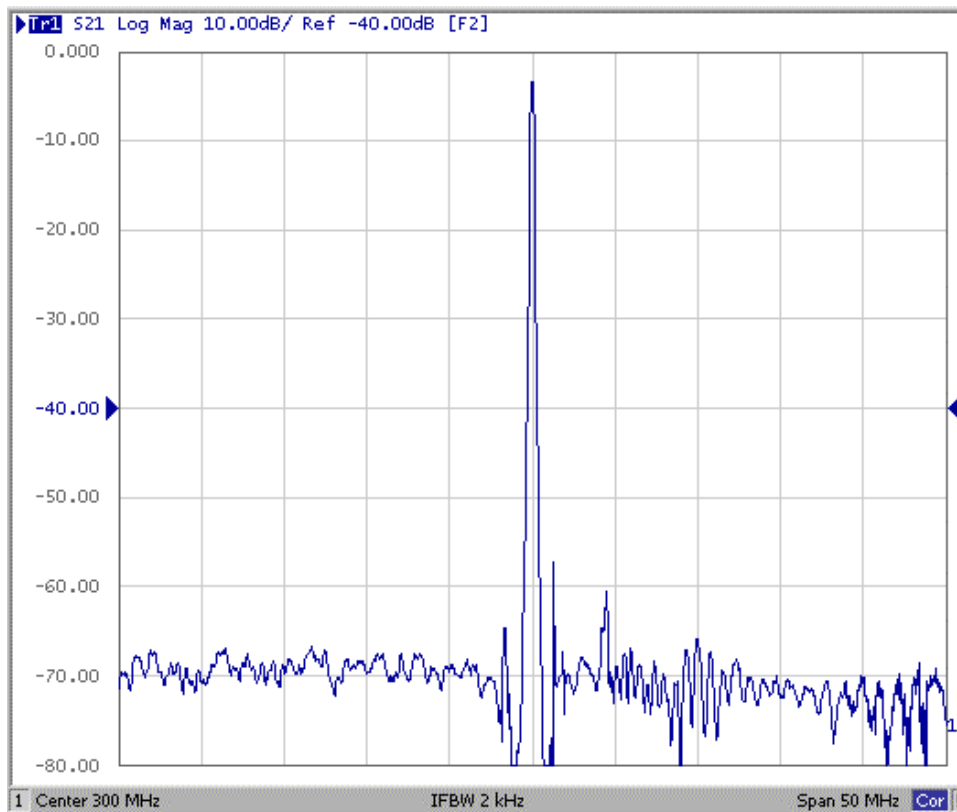
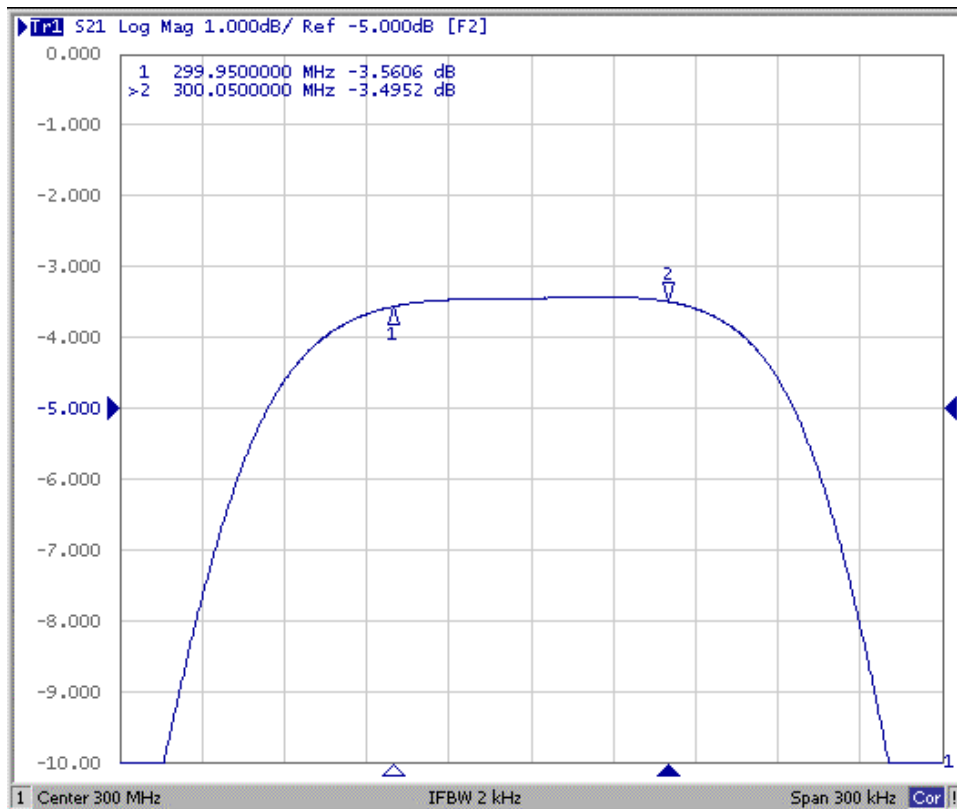

## Reflection Functions :

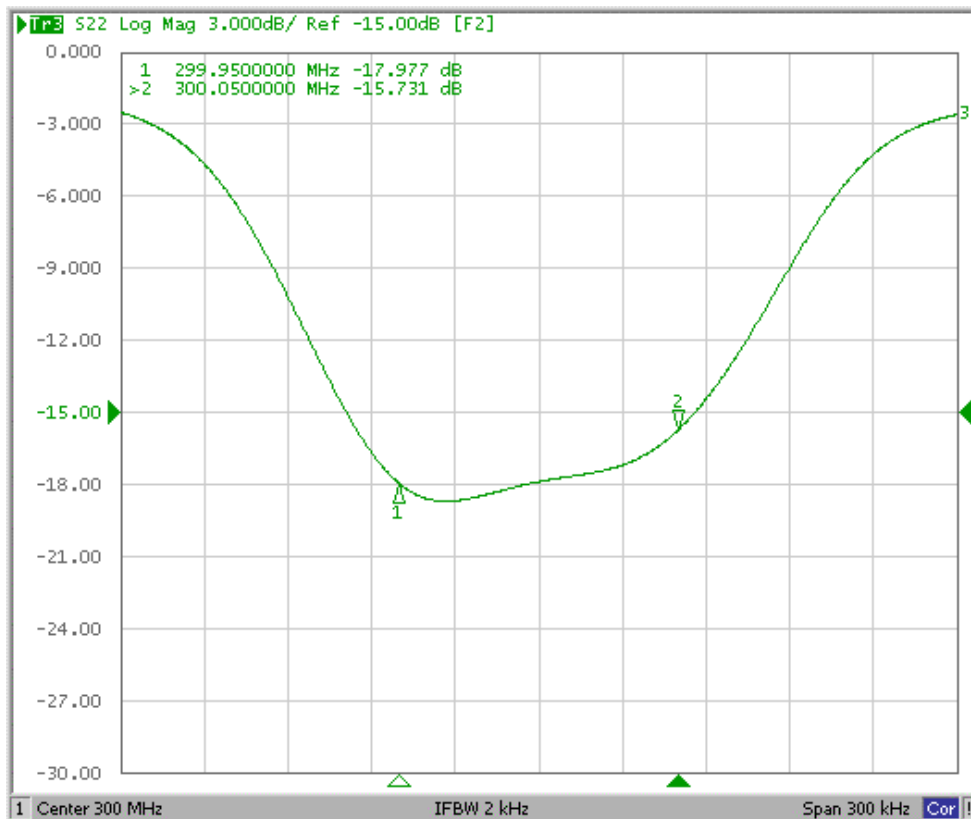
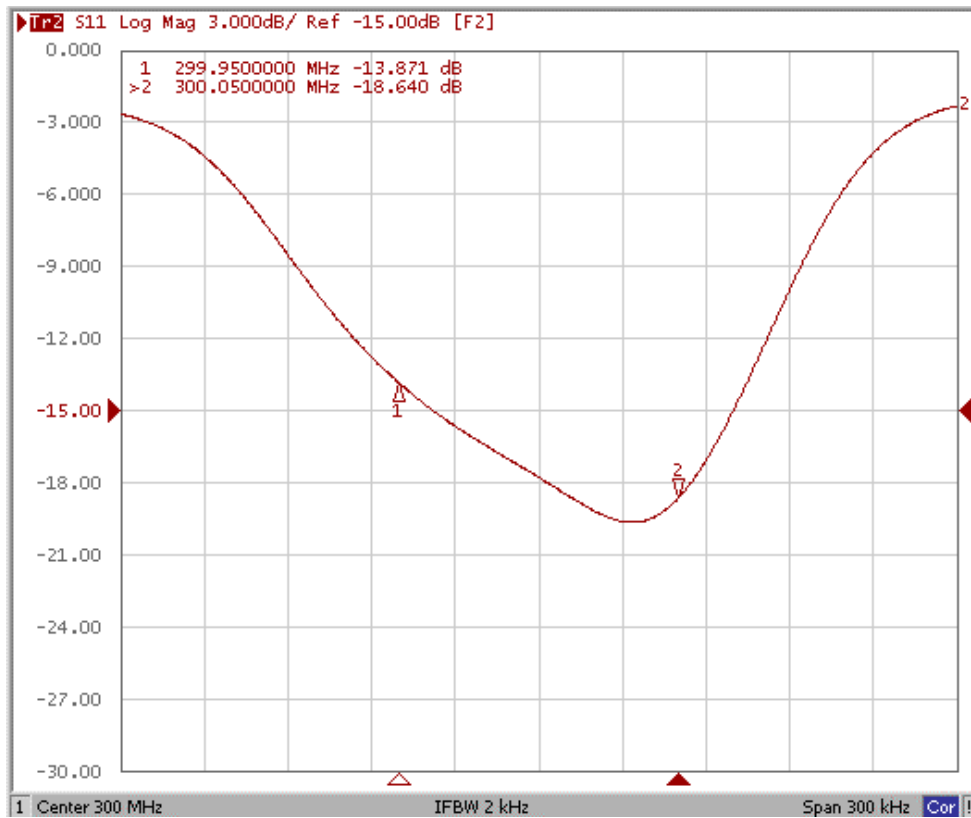

**G. PACKING:**  
**1. REEL DIMENSION**

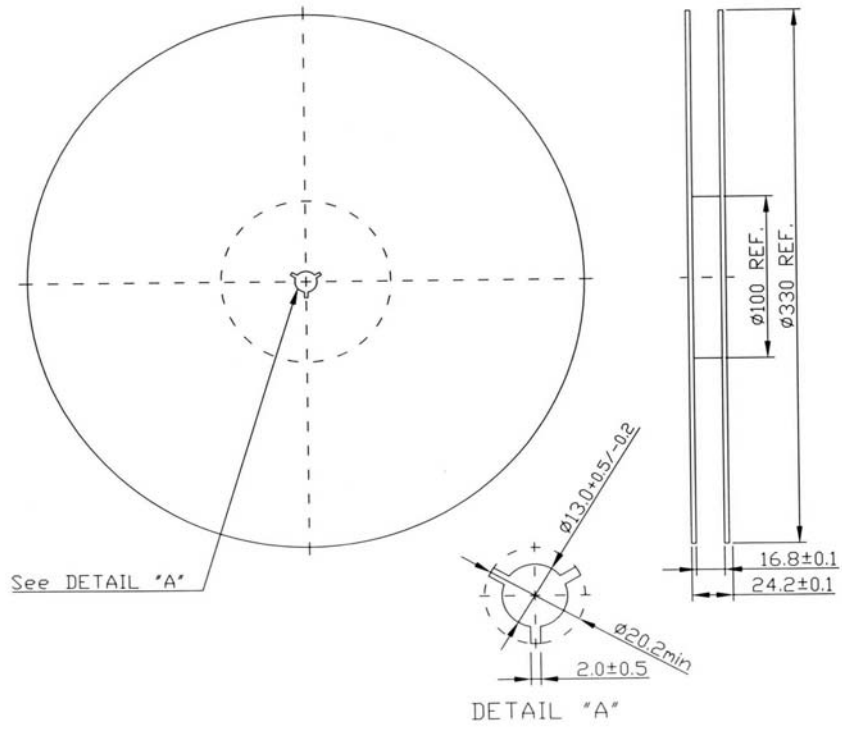

**2. TAPE DIMENSION**

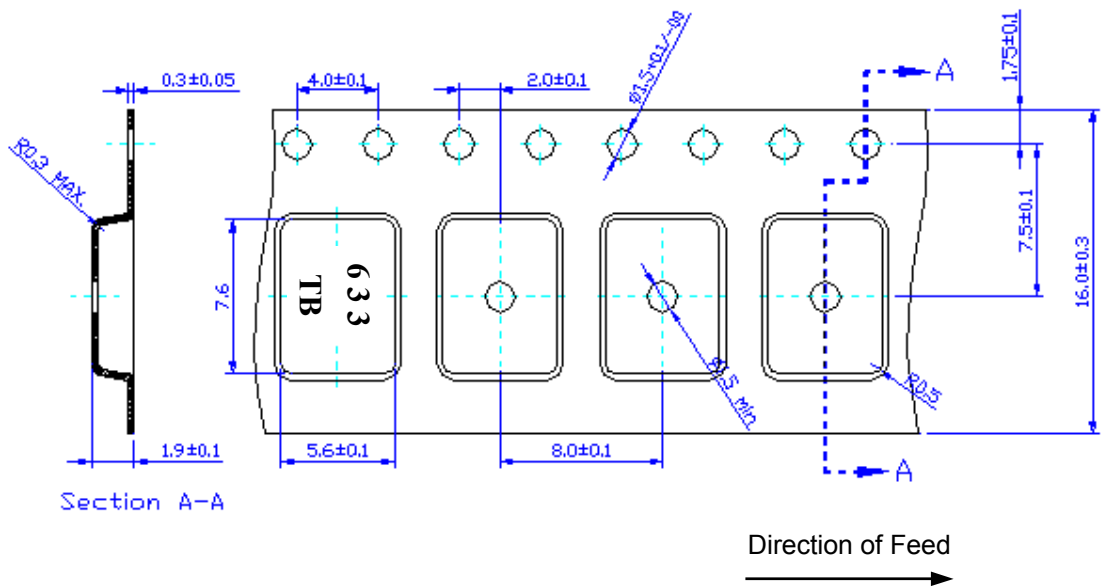

## H. RECOMMENDED REFLOW PROFILE :

