

ONE-PIECE SHIELDS

SGH-26,21x26,21x5,08x0,20-FS-OP

3D VIEW

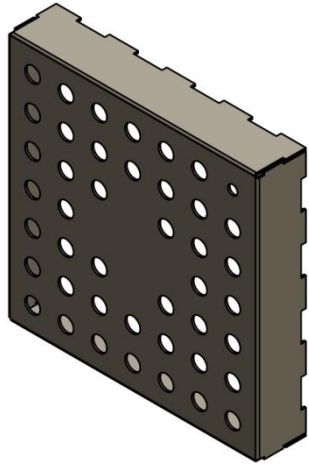

DIMENSIONS (mm)

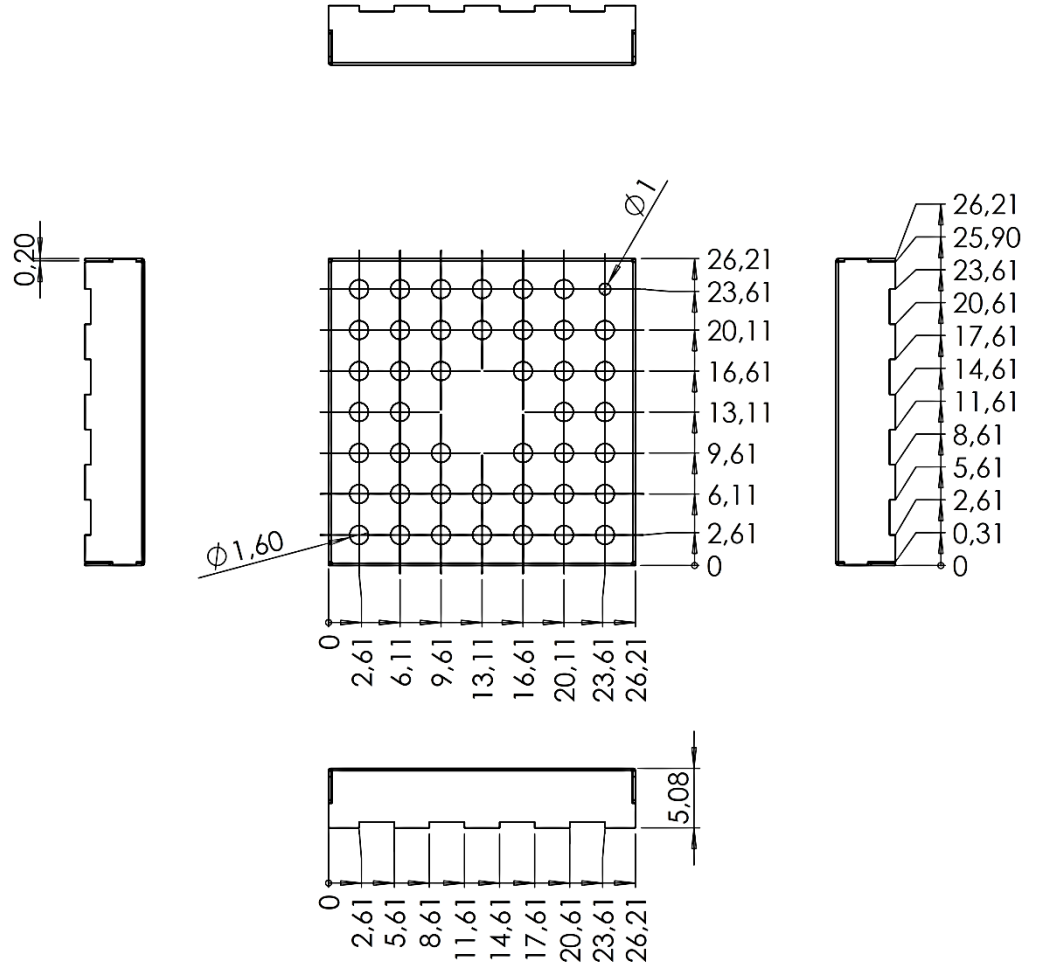

Property	Value	Tolerance
Thickness	0,20 mm	ISO 2768-mK
Length	26,21 mm	ISO 2768-mK
Width	26,21 mm	ISO 2768-mK
Height	5,08 mm	ISO 2768-mK
Material	SPTE	
Plating	Tin-plated	

ONE-PIECE SHIELDS

SGH-26,21x26,21x5,08x0,20-FS-OP

RECOMMENDED FOOTPRINT (mm)

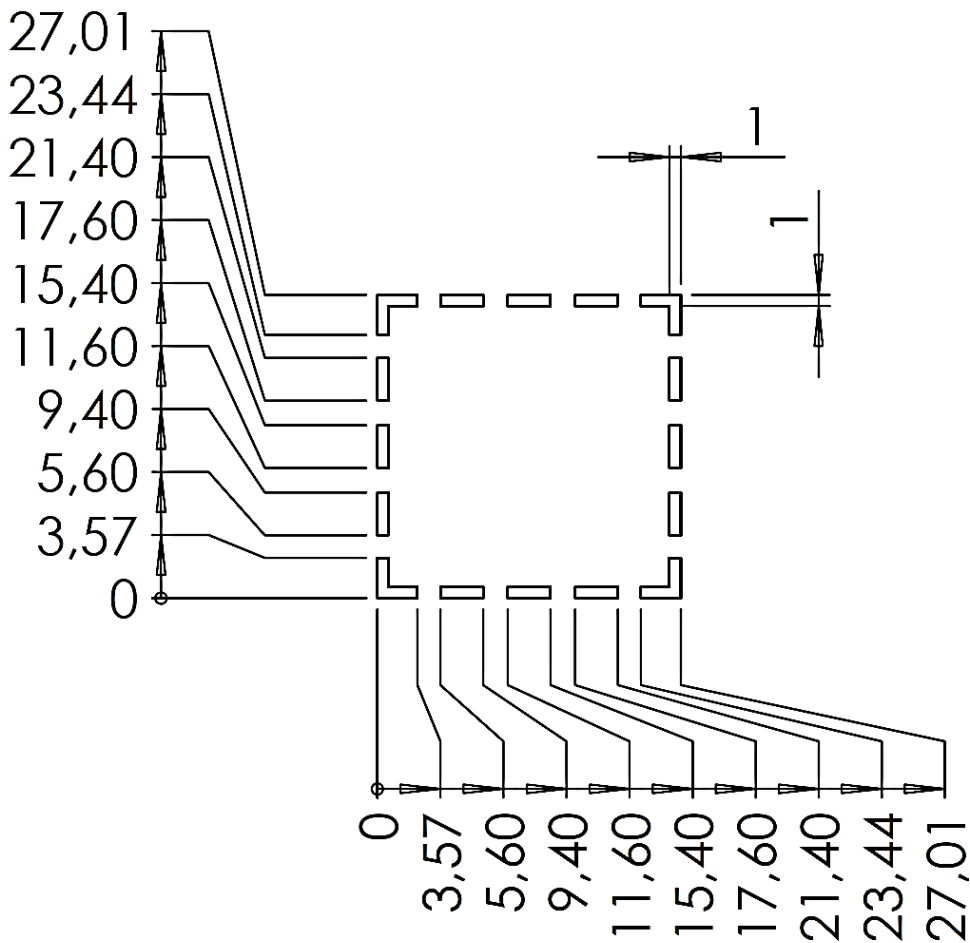

Disclaimer: This is only a recommendation based on information available to **mtc** at the time of printing. Actual land pattern can be significantly different due to various materials and processes used in PCB assembly. **mtc** makes no representation or warranty of performance based on the recommended land pattern.

